

# atom<sup>®</sup>

## INSTALLATION SHEET

### LED PANEL

### AT6021/312 - SER II

36W LED Backlit Panel 300 x 1200

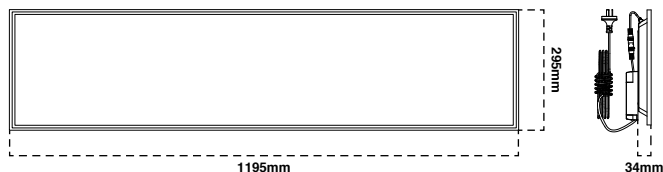

#### Product Specification

Voltage			220-240V~ 50Hz		
Wattage			36W		
Light colour options		Cool white	Daylight		
Colour temperature		4000K	5700K		
Lumen output		3680lm	3560lm		
Finish			White		
Colour rendering index			> 80		
Dimmable			No		
Warranty			3Y/15000Hr*		
Working temperature			-10°C – 40°C		
IP Rating			IP40		
Electrical classification			Class II		

\*3Y/15000Hr operation time (whichever arrives first) subject to all Warranty Conditions

#### IMPORTANT INFORMATION

- Luminaires must be installed and fitted by a licensed electrician strictly in accordance with the current revision of AS/NZS 3000 - Electrical installations (Australia/ New Zealand wiring rules).
- Do not install this product on damp or newly plastered ceilings.
- Do not connect LEDs directly to 230V, use the power equipment.
- Luminaires design stipulates a normal usage 16 hours for commercial applications.
- Non-user replaceable light source: Light source contained in this luminaire shall only be replaced by the manufacturer or his service agent or similar qualified person.

This product may contain substances that can be hazardous to the environment if not disposed of properly. Electrical and electronic equipment should never be disposed of with general household waste but must be separated of its correct treatment and recovery. Where possible recycle your packaging. Please keep these instructions safe for future reference.

#### Installation

Read instructions and check you have all the tools and accessories to complete the installation correctly.

1. Isolate the mains power supply before commencing installation (Fig. 1)
2. Feed the mains cable through ceiling recess and plug into the mains supply. (Fig. 2)
4. Insert panel and driver through ceiling recess (Fig. 4), and secure in location. Panel should sit flush against the T-bar ceiling grid (as shown in Fig. 4), and driver should sit on ceiling adjacent to panel.

Note, always ensure driver and panel are not covered by insulation.

5. Reconnect mains power and switch on to operate (Fig. 5)

FIG. 1

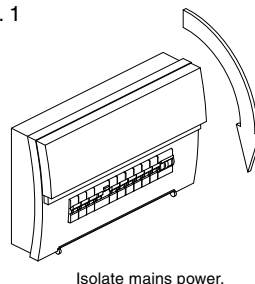

FIG. 2

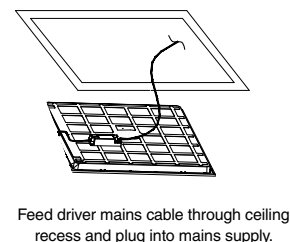

FIG. 3

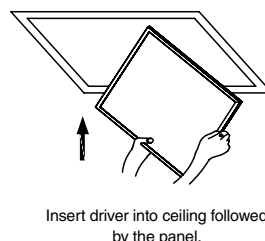

FIG. 4

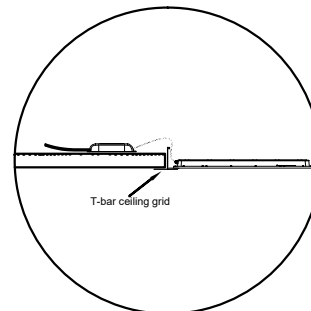
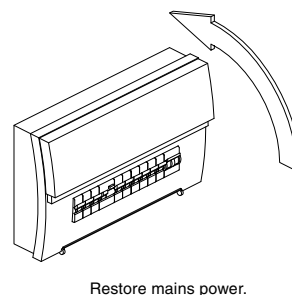

FIG. 5



Panel should sit flush against, and supported by the T-Bar grid.

#### Product Range

SKU	Code	Description
12625	AT6021/306/CW - SER II	20W LED Backlit Panel 300 x 600 - 4000K
12626	AT6021/306/DL - SER II	20W LED Backlit Panel 300 x 600 - 5700K
12627	AT6021/312/CW - SER II	36W LED Backlit Panel 300 x 1200 - 4000K
12628	AT6021/312/DL - SER II	36W LED Backlit Panel 300 x 1200 - 5700K
12629	AT6021/606/CW - SER II	36W LED Backlit Panel 600 x 600 - 4000K
12630	AT6021/606/DL - SER II	36W LED Backlit Panel 600 x 600 - 5700K
12631	AT6021/612/CW - SER II	60W LED Backlit Panel 600 x 1200 - 4000K
12632	AT6021/612/DL - SER II	60W LED Backlit Panel 600 x 1200 - 5700K

Risk of Fire

CAN BE COVERED AND ABUTTED

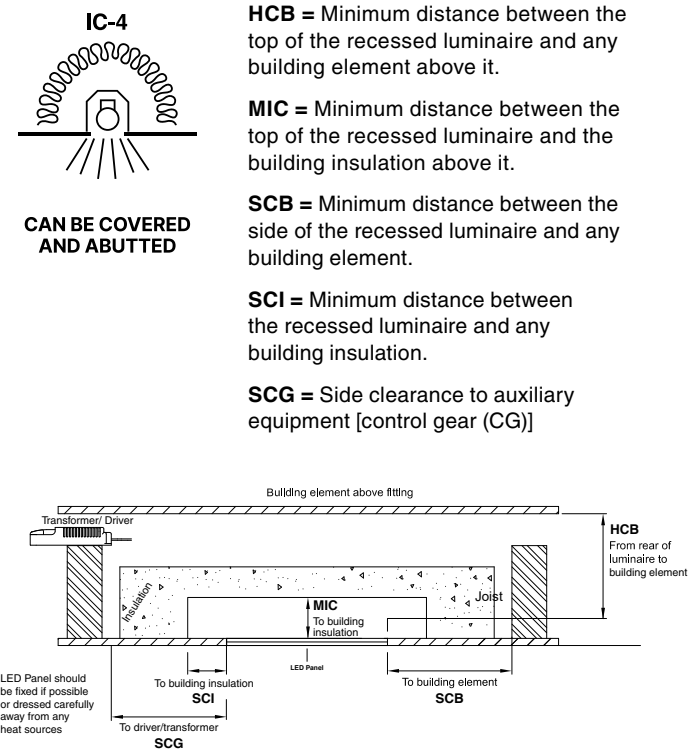

Risk of Fire - Required clearance from structural members and building elements.

**BUILDING INSULATION MUST NOT COVER THIS LUMINAIRE.**

HCB: 100mm	MIC: 100mm	SCB: 30mm	SCI: 100mm	SCG: 50mm
------------	------------	-----------	------------	-----------

Transformer/LED Driver

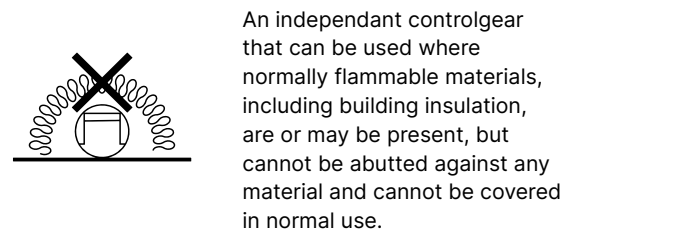

Risk of Fire - Required clearance from structural members and building elements.

**BUILDING INSULATION MUST NOT COVER THIS LUMINAIRE.**

HCB: 25mm	MIC: 10mm	SCB: 25mm	SCI: 15mm
-----------	-----------	-----------	-----------

Driver models supplied with the AT6021/312.

Code	Description
AT9646	LED Driver Constant Current 900mA

**Warning: Risk of overheating or fire if the clearance distances are compromised.**

Warranty

Atom products are distributed in Australia by Evolt Pty Ltd ('us', 'our', or 'we'). Our contact information is set out in the bottom right hand corner of this page.

Our goods come with guarantees that cannot be excluded under the Australian Consumer Law. You are entitled to a replacement or refund for a major failure and compensation for any other reasonably foreseeable loss or damage. You are also entitled to have the goods repaired or replaced if the goods fail to be of acceptable quality and the failure does not amount to a major failure.

In addition to your guarantees under the Australian Consumer Law, our goods also come with a contractual warranty, which is described below. This warranty is additional to your rights under the Australian Consumer Law (and any other rights or remedies you may have under a law in relation to the products) and is not intended to modify or exclude those rights.

Subject to the terms of this contractual warranty, if your Atom products are defective, we will (at our election) repair or replace the Atom products. Once we make this election (and take the relevant action), we will have honored our obligations under this contractual warranty.

Our total liability under this warranty is limited to the cost of repair or replacement of the defective product (at our election). We otherwise exclude all liability in relation to the product to the fullest extent permitted by law (noting our comments above regarding the Australian Consumer Law and any other rights or remedies you may have).

If you wish to claim under this warranty, you must, at your own expense, return the product or that part of the product which you believe is defective, together with proof of original purchase, your name, address and telephone number and a certificate of installation (or other document required by the law for the installation of electrical products in the place in which the product was installed) to Evolt at the address set out in the bottom right hand corner of this page within the warranty period. You bear all costs associated with claiming under this warranty (including, but not limited to, postage costs). Without limiting the preceding sentence, this warranty does not apply to the costs of the removal or re-installation of the defective product.

The warranty period for this product is Three Years from the date of purchase or 15,000h operation time (whichever arrives first). This warranty is not transferable and is only given to the original purchaser of the product, provided the purchaser has purchased the product from us. Proof of purchase must be provided to us with any warranty claim. We recommend that you attach your proof of purchase to your product manual.

This warranty does not apply to consumable items within your product (including, but not limited to, lamps or batteries). This warranty does not apply to products that have been improperly stored, installed, or used. This warranty does not apply to products that have not been maintained in accordance with the instructions contained within this product manual.

This warranty does not apply to loss or damage caused by wear and tear, misuse, incorrect installation or operation, failure to clean and maintain, incorrect voltage or non-authorized electrical connections, adverse external conditions (such as power surges and dips, acts of God, exposure to heat, corrosion, insect or vermin infestation), use of non-authorized or defective parts or globes, or to items that have been repaired than by a person other than us or a repairer approved by us.

**Atom is a registered brand of Evolt Pty Limited.**  
For further information please call Evolt's head office on 1300 4EVOLT (438 658).  
Evolt Pty Limited PO BOX 271 KINGSGROVE NSW 1480  
ABN 83 112 123 529

Due to changes in industry standards and Evolt's policy of continual product development, product specifications are subject to change without notice.  
Images are for illustrative purposes only.